

PC360 Software Beta

Installation & User Guide

V.1.0 (3)

Table of Contents

Introduction

01 About the PC360

Getting Started

02 Installing and Download Guide

03 System requirements

04 Preparing to use PC360 software (Bluetooth Assistance)

Layout

05 Main

06 Capture

07 Edit

08 Export

Using the PC360

09 Shooting photos and videos

10 Device and camera control

11 Editing photos

12 Exporting 360 image and videos

Menu List

INTRODUCTION

About the PC360

PC360 is a photo shooting/editing PC tool that allows you to conveniently view 360 images by linking PC, camera, and Foldio360. The user can shoot the photo with a full control of both camera and Foldio360 by connecting the camera to PC360 via USB, and connecting to Foldio360 via bluetooth.

The user can conveniently create 360 images after editing the captured photos, and it can be exported as a file format.



| GETTING STARTED

Installing the software on a PC

1. Access the "PC360 Software Guide Page" in Orangemonkie shop.
* "Download" link : us.orangemonkie.com/pc360-software



2. Select and download Window / Mac install file.



[MAC Download]
AppStore Link



[Windows Download]
MSI File Download Link

3. After the installation, run the program. Please read the next slide for download instructions for Mac and Windows.

Mac Download Guide: *Page 5-6*

Windows Download Guide: *Page 7*

GETTING STARTED



Mac Download Guide

1. Download Software from our website, and click **"Allow"** in the below pop-up.

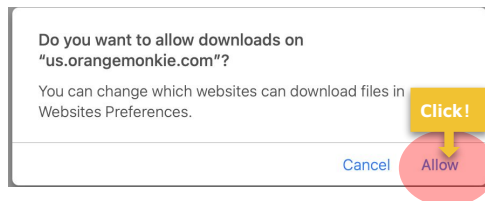

2. You should see the software downloading.



3. After the software has downloaded, you should see this notification sign below.

Apple is taking security measures, but this does not necessarily mean that the app has malware so please don't get worried. This warning simply means that macOS does not recognize the app (or the developer).

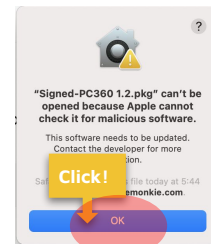

4. Open our Mac's **"System Preferences"**, and click **"Security & Privacy"**

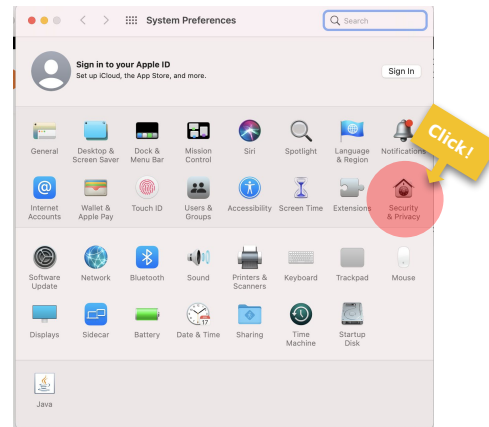

Cont. →
Next Page

| GETTING STARTED



Mac Download Guide

5. Click on the "General" Tab, and then click "Open Anyway"

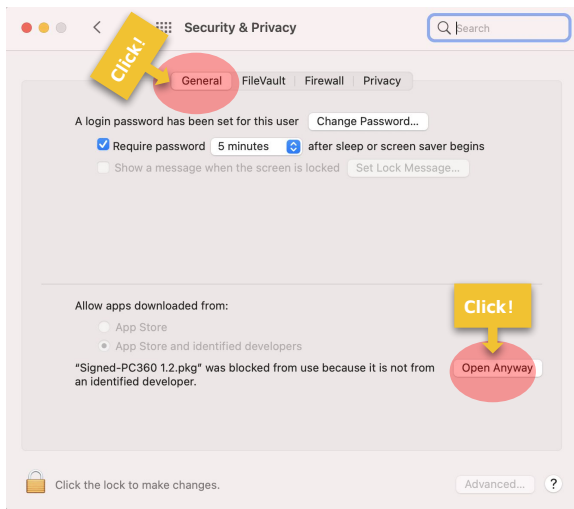

6. Click on "Open"

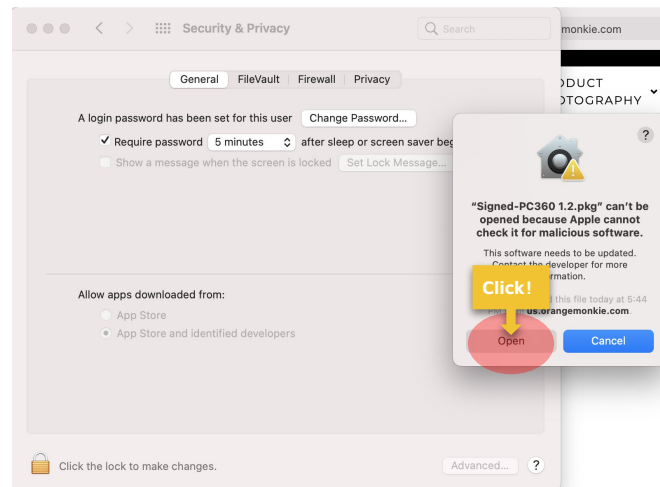

GETTING STARTED



Windows Download Guide

1. Download Software from our website.

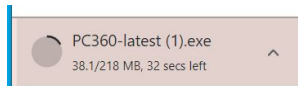

2. After the software has downloaded, you should see this notification sign below. Click on **"More Info"**. Windows is taking security measures, but this does not necessarily mean that the app has malware so please don't get worried. This warning simply means that Windows OS does not recognize the app (or the developer).

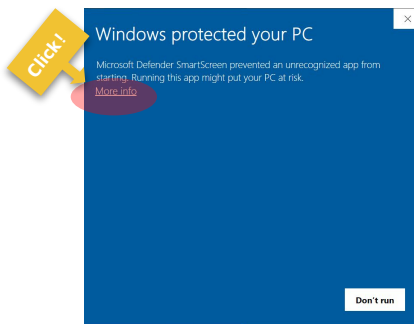

6. Click on "Run anyway"



7. The Software should install.

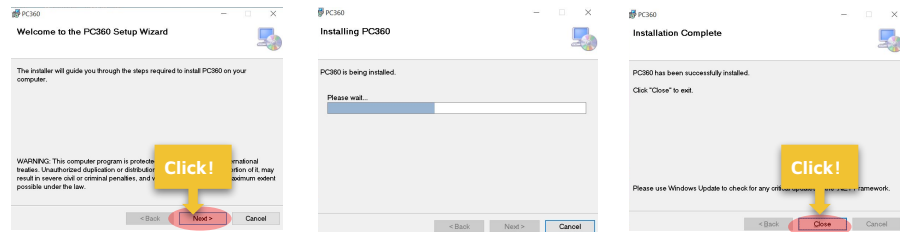

8. The PC360 Beta should be downloaded on your desktop.



System requirements

1-1. PC - MAC Minimum System Requirements

CPU	2.2 GHz Intel Core i5 and above or M1 Chip
RAM	More than and equal 8GB 1600 MHz DDR3
Free Space	20 GB
Bluetooth Version	BT4.0 and above
OS Version	10.14 Mojave and above
Graphics	Intel Iris Graphics

2. Camera System Requirements

CANON, NIKON, SONY, PANASONIC, ETC.	For List of Supported Cameras please click here .
---	---

3. Foldio360 Device System Requirements

Foldio360	Foldio360 Turntable
	Foldio360 Smart Dome

1-2. PC - Windows Minimum System Requirements

CPU	2.0 GHz Intel Core i5 or above
RAM	12GB 1600 MHz DDR3
Free Space	20 GB
Bluetooth Version	BT4.0 and above
OS Version	Windows 10 and above
Graphics	Intel HD Graphics
Total Number of Cores	4
L2 Cache (Per Core)	256 KB
L3 Cache	3 MB
Hyper-Threading Technology	Enabled

Preparing to use PC360 software (Bluetooth Assistance)

To use PC360, the user needs a program installed PC (Mac or Window), Foldio360 device (Turntable or Smart Dome), and supportable camera (DSLR or Mirrorless)

1. Run PC360.
2. Connect camera to PC via USB.
3. Turn on bluetooth and connect Foldio360 to your PC.

Windows Users

- If you are a Windows user, you need to make sure to go to your Bluetooth Settings from your Windows.
- After going to your Bluetooth Settings, you need to make sure to select "Foldio360" or "Foldio360D".
- After selecting the correct Foldio360 Product, you should see "Foldio360" or "Foldio360D" as an option to control.

Mac Users

- Mac Users will just need to make sure that on their Mac Bluetooth Settings is turned on.

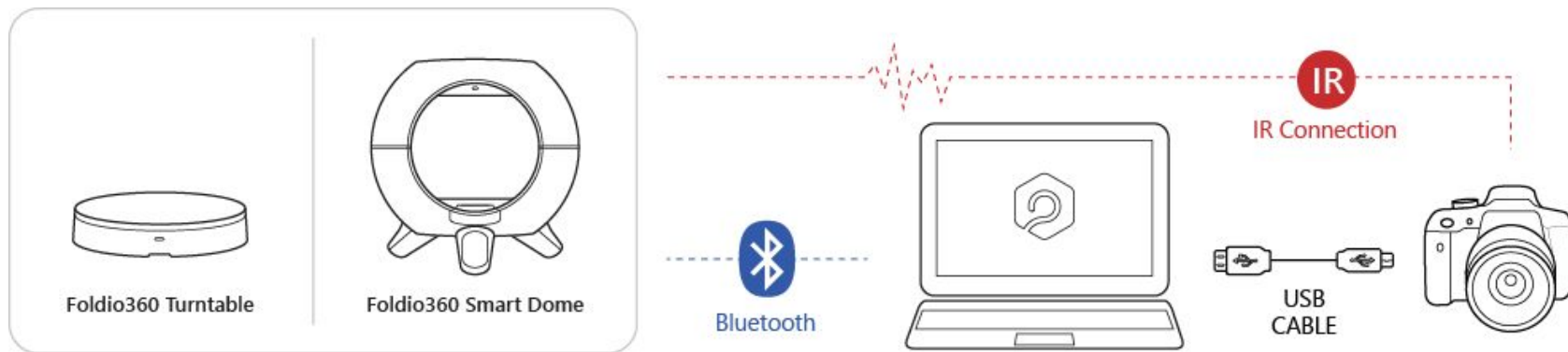

LAYOUT

Main

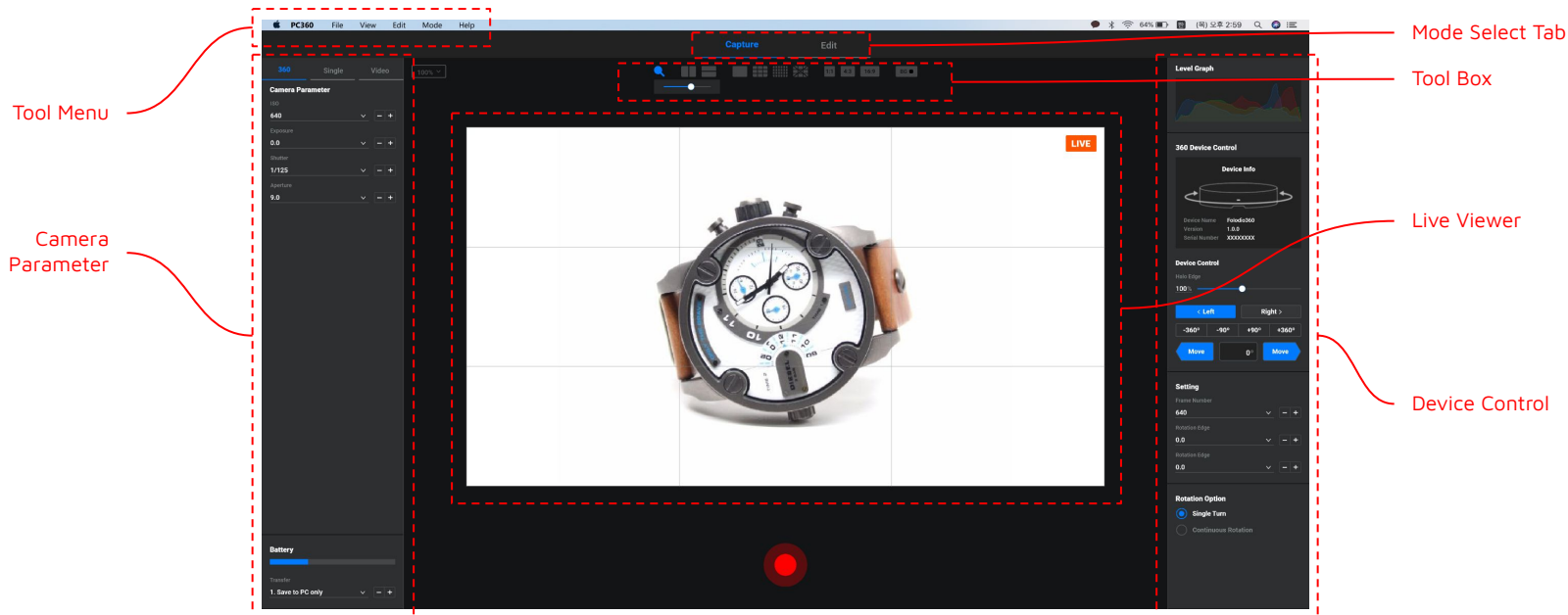

Capture

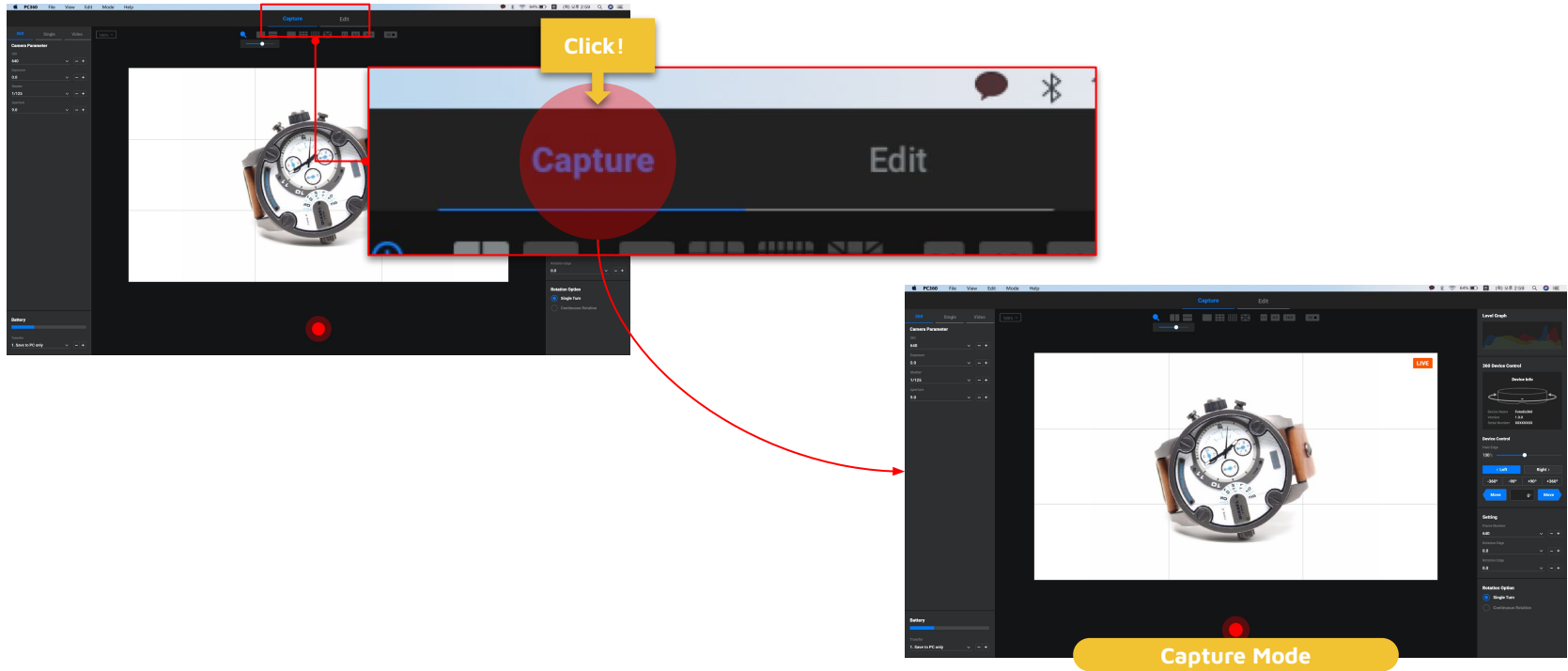

Edit

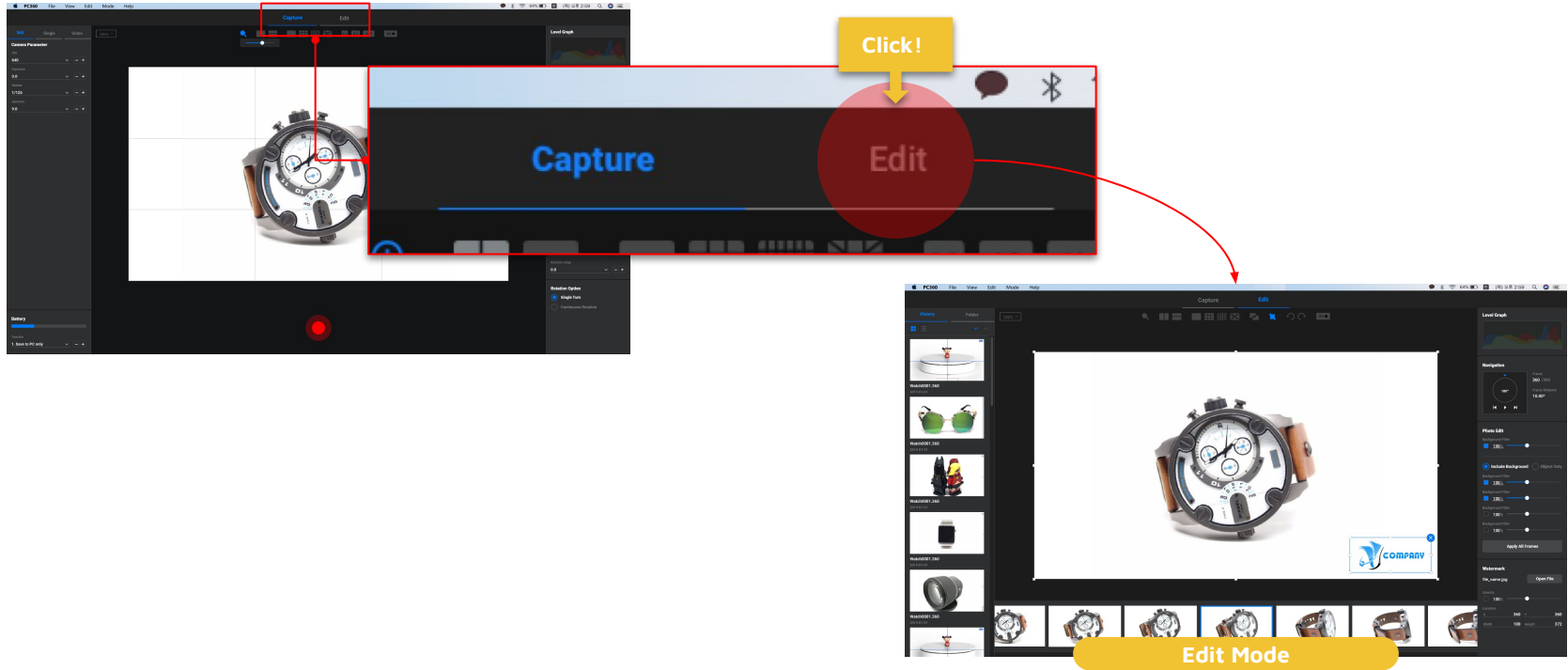

Export

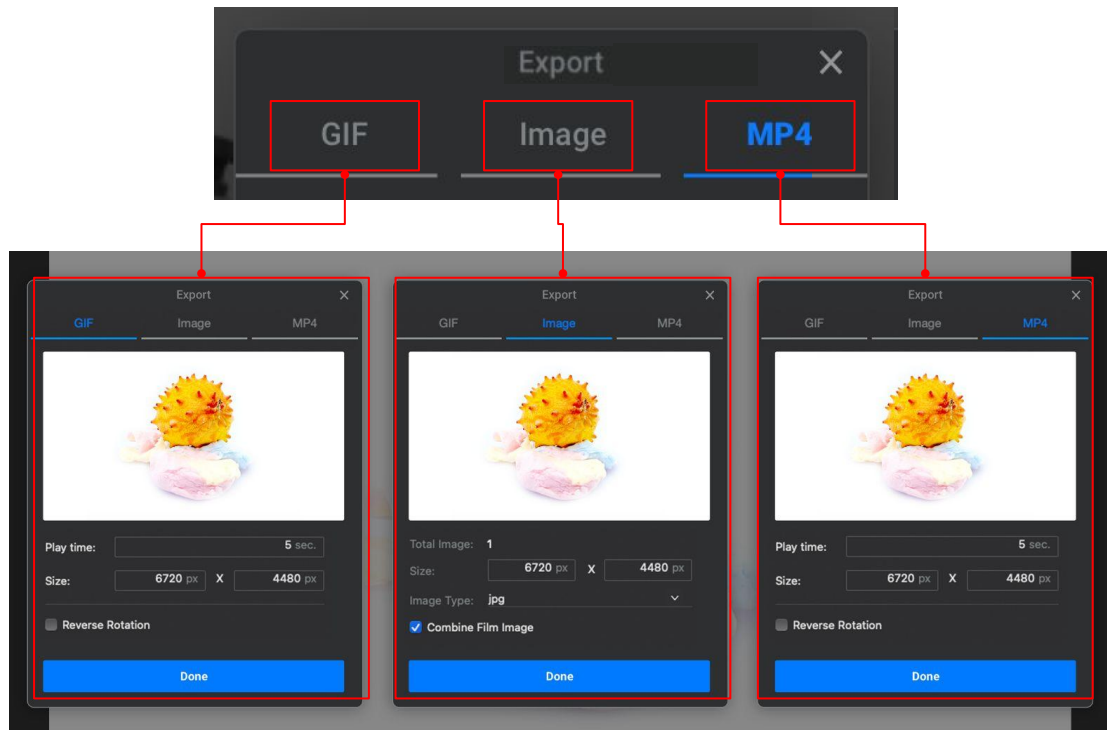

USING THE PC360

Shooting photos and videos

1. After launching the program, connect the camera to PC360, select the desired shooting menu (360, Single, or video)

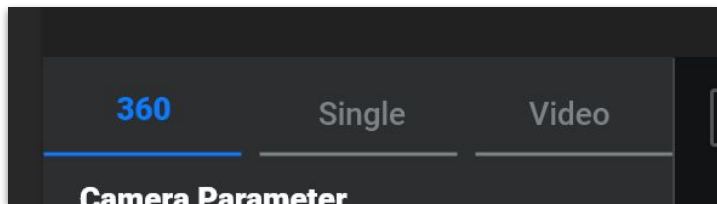

360 Mode	360 shooting according to the set camera and Foldio device settings
Single Mode	Single shooting according to the set camera and Foldio device settings
Video Mode	Video shooting according to the set camera and Foldio device setting

2. Check and adjust the parameter value of the connected camera.

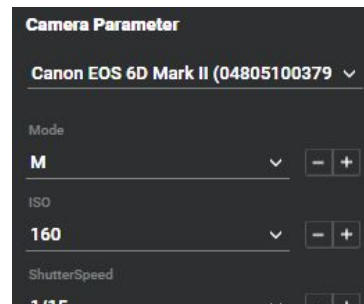

Mode	Set by synchronizing the camera mode
ISO	Set the ISO value
Exposure	Set the exposure value
Shutter Speed	Set the shutter speed value
...	Set the parameter value provided by each camera
Battery	Display the battery level

3. Controls the connected Foldio device and sets the shooting value.

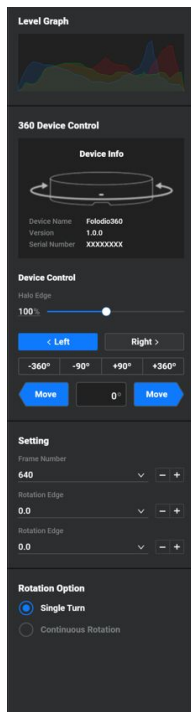

Turntable

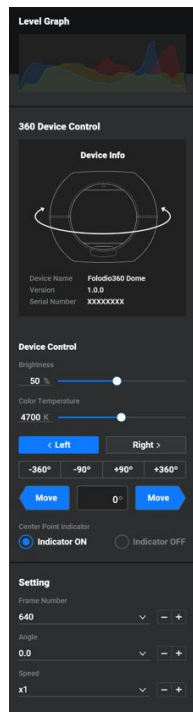

Smart Dome

[Device information & control]

Level Graph	Display RGB histogram of viewer image
Device Info	Display the information and status of connected Foldio device
Halo Edge (Turntable)	Set the brightness of Halo Edge of turntable
Brightness (Smart Dome)	Set light brightness of Smart Dome
Color Temperature (Smart Dome)	Set color temperature of Smart Dome
Device Control	Set rotation of turntable
Center Point Indicator (Smart Dome)	Turn on/off the center point indicator

Frame Number (360 Mode)	Set frame number (Select 24,36,48)
Angle (360 Mode)	Set rotation angle (Rotate Left or Right, +-90, +-360, and customizable angle)
Speed (360 & Video Mode)	Set rotation speed (1x, 2x, 3x)
Rotation Option (Video Mode)	Set rotation option of turntable (Select single rotation or continuous rotation)

4. Check the screen to be shot in live view and adjust it using the function of the toolbox

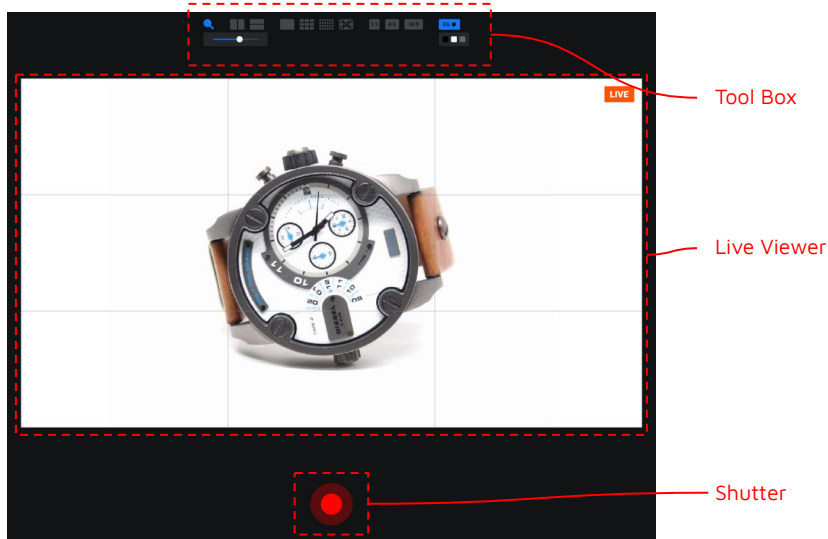

[Toolbox function]

Viewer Size	Set viewer size (50%, 60%, 70%, 80%, 90%, 100%, Auto[Full ratio])
Zoom	If you select the zoom function, a slide is created at the bottom, and the image is displayed by zooming in the viewer area (Set the value using slider, minimum 100% - maximum 500%)
Vertical Guideline	Display vertical guideline
Horizontal Guideline	Display horizontal guideline
No Grid	No grid
3x3 Grid	Display 3x3 Grid
6x4 Grid	Display 6x4 Grid
3x3 & Diagonal Grid	Display 3x3 & Diagonal Grid
1:1 Ratio	Display viewer ratio to 1:1
4:3 Ratio	Display viewer ratio 4:3
16:9 Ratio	Display viewer ratio 16:9
Background Color	Set background color (Select Black, Gray, White)

5-1. 360 Shooting mode : When the shutter button is pressed, the turntable rotates according to the set value and shoot 360 degree image.

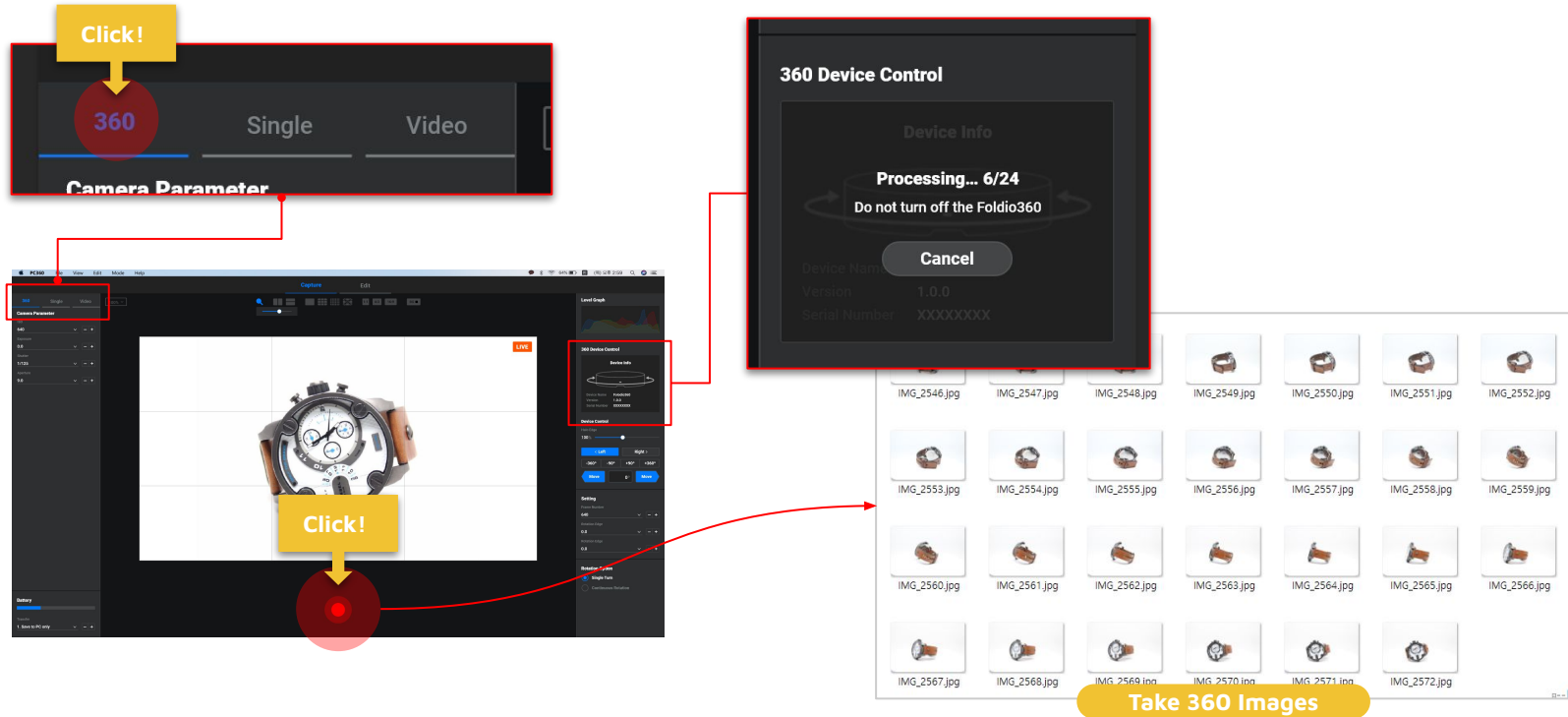

5-2. Single shooting mode : When the shutter button is pressed, a single image is taken at the desired view point according to the set value

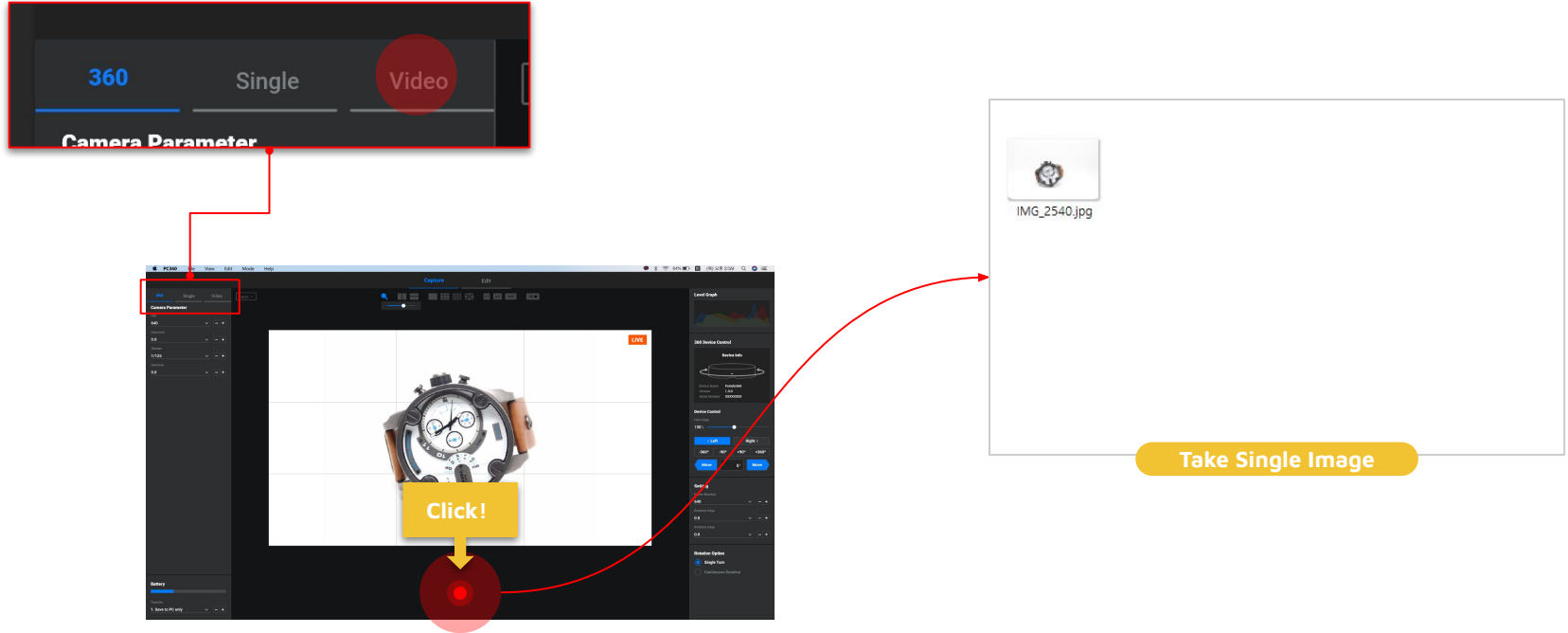

5-3. Video Shooting Mode : When the shutter button is pressed, the turntable rotates according to the set value and records a video..

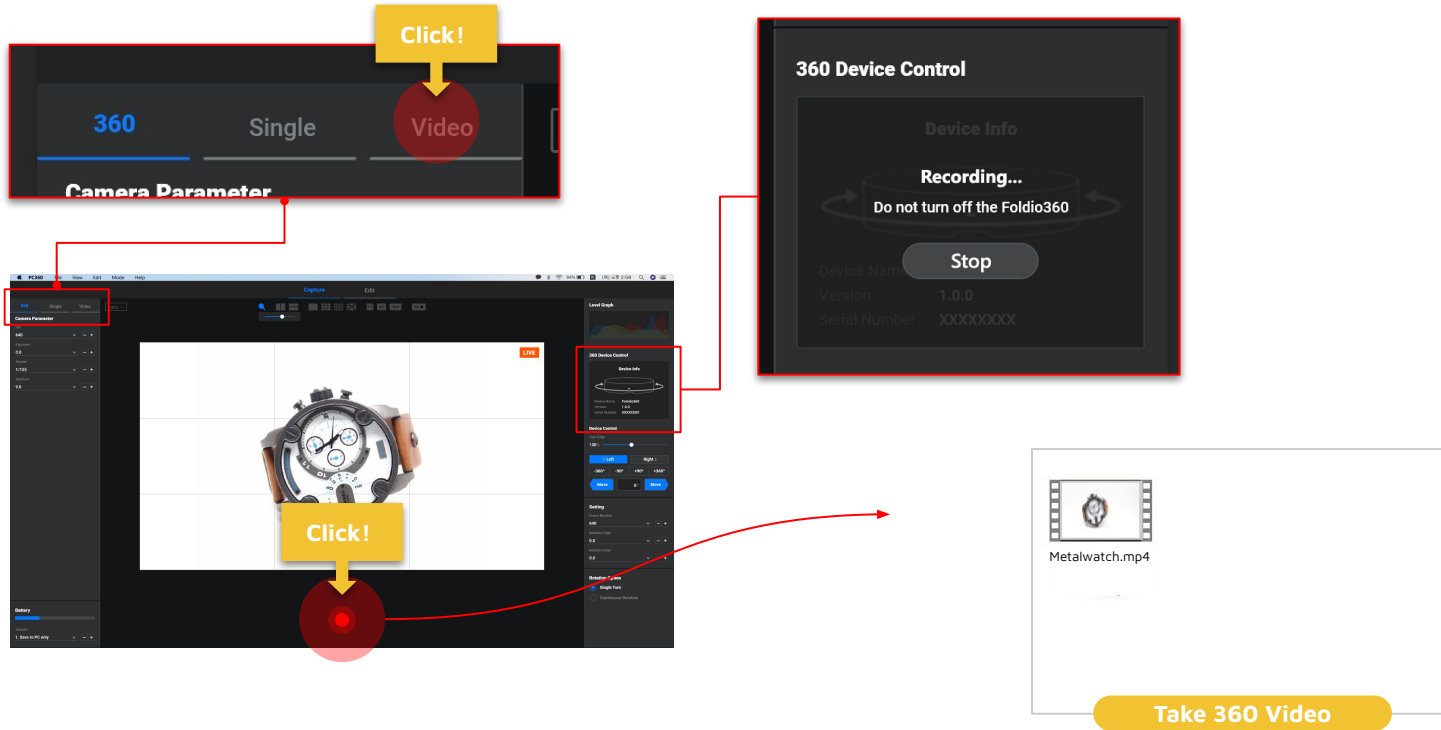

6. Save your shoots to a specific location on you OS.

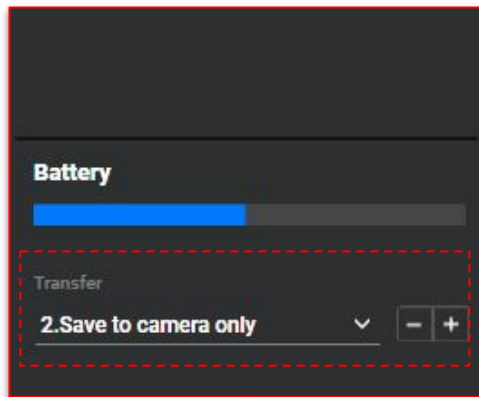
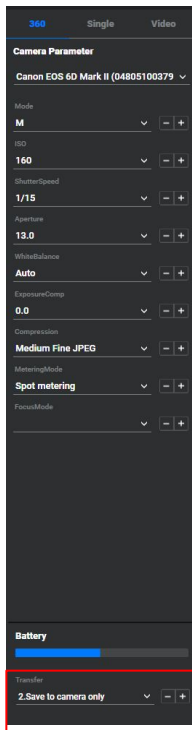

[Save method setting]

Save to PC only	Only save the result to PC. Select the desired saving folder, the result will be saved in the selected saving folder.
Save to Camera Only	Save the result to the connected camera
Save to PC & Camera	Save the result to the both PC and camera.

Editing photos

1-1. Load from history tab : Import saved 360 file from history tab.

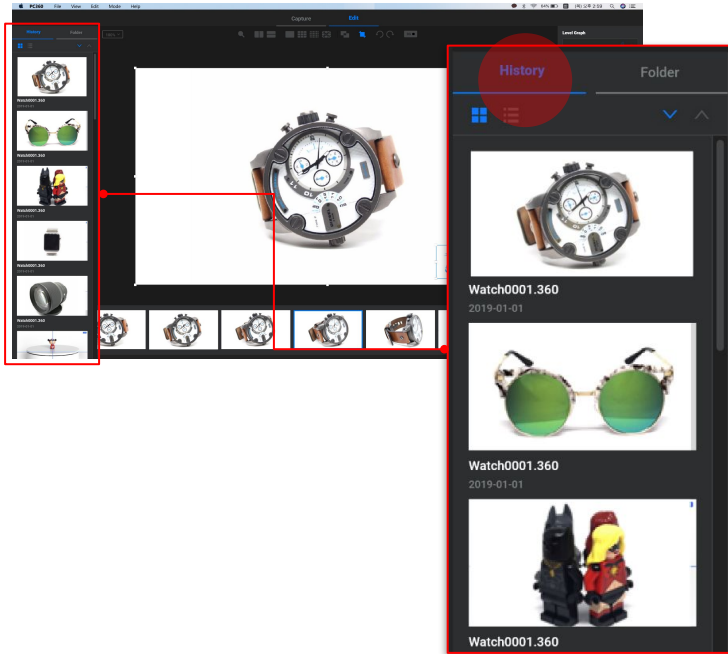

1-2. Load from history tab : Adjust the way thumbnails are viewed and its arrangement in the history tab.

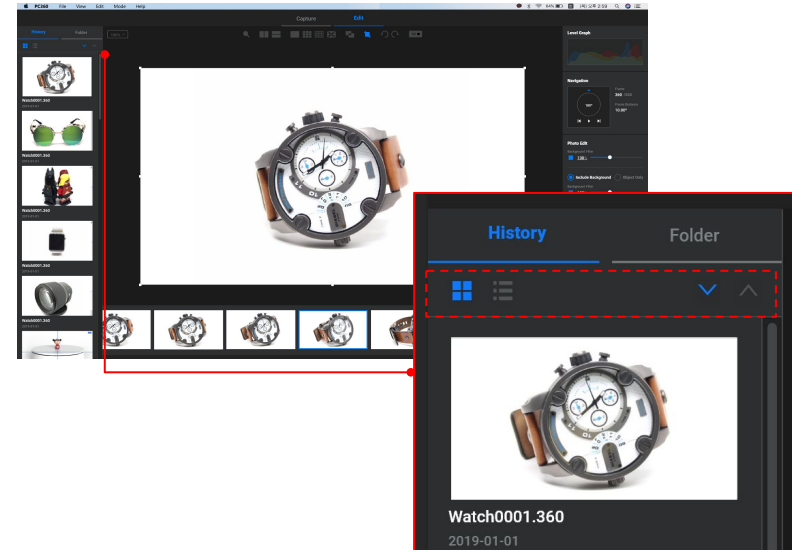

1-3. Load from history tab : Select the file the user wants to edit among the 360 files in the history and edit the image.

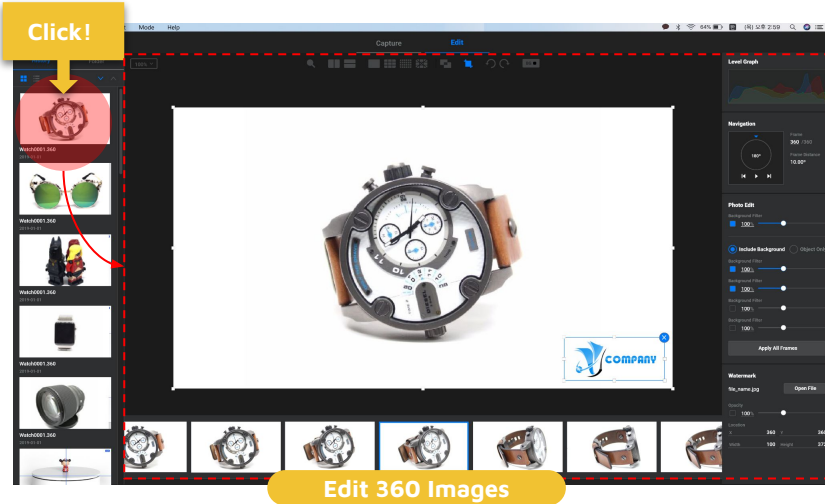

2-1. Load from folder tab : In the folder tab, select a folder on your PC to load desired 360 files

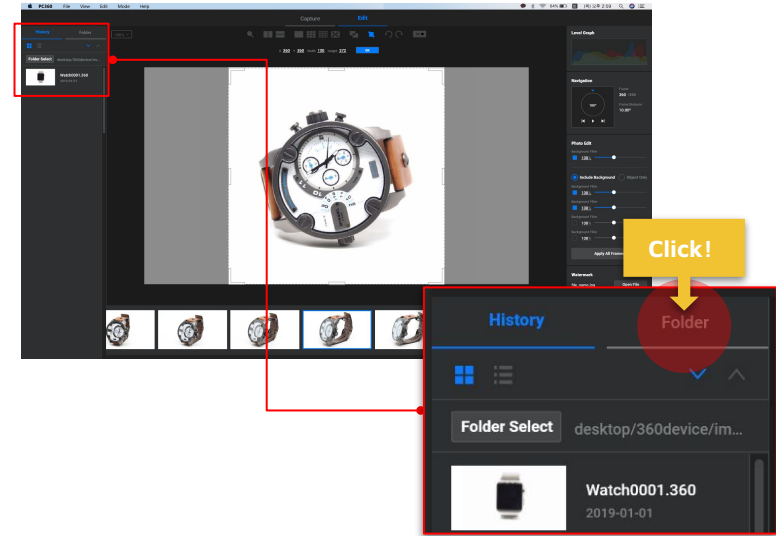

2-2. Load from folder tab : Adjust thumbnails way of view

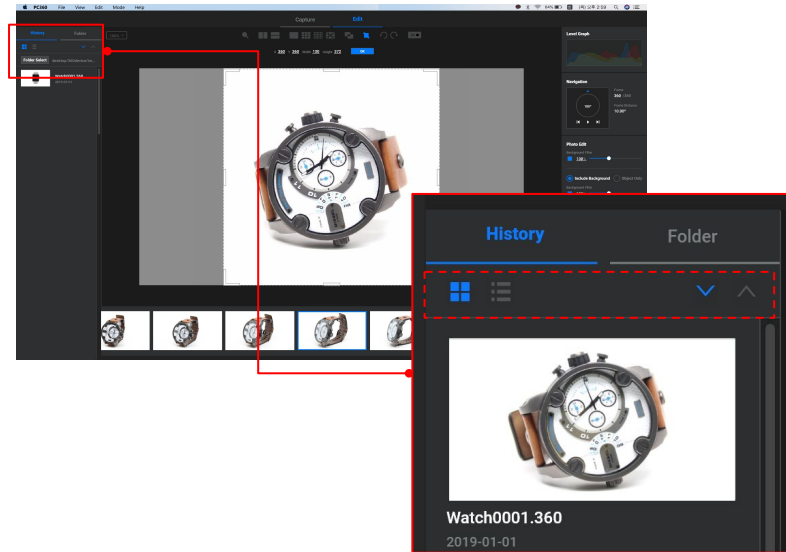

2-3. Load from history tab : Select the file the user wants to edit among 360 files in the folder tab and edit the image.

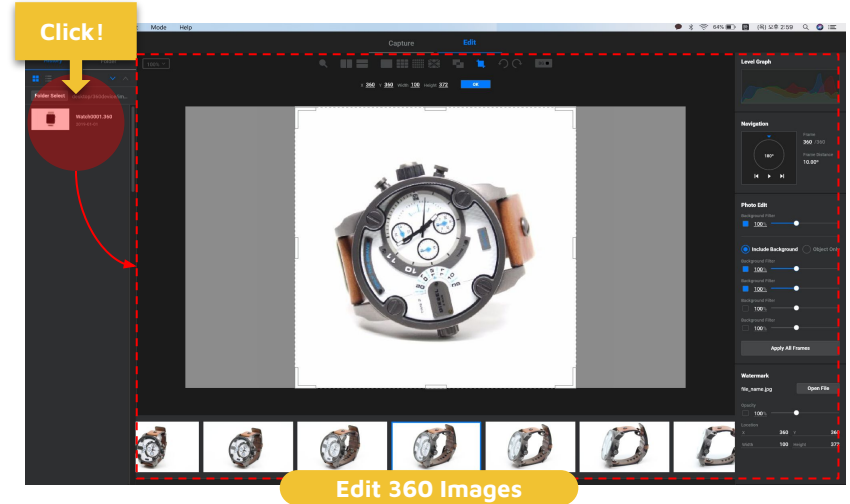

3. The images of each frame that make up the 360 files imported from the history or folder tabs are shown in the timeline at the bottom. After selecting the frame user wants to edit, the image can be edited by using the toolbox and filter

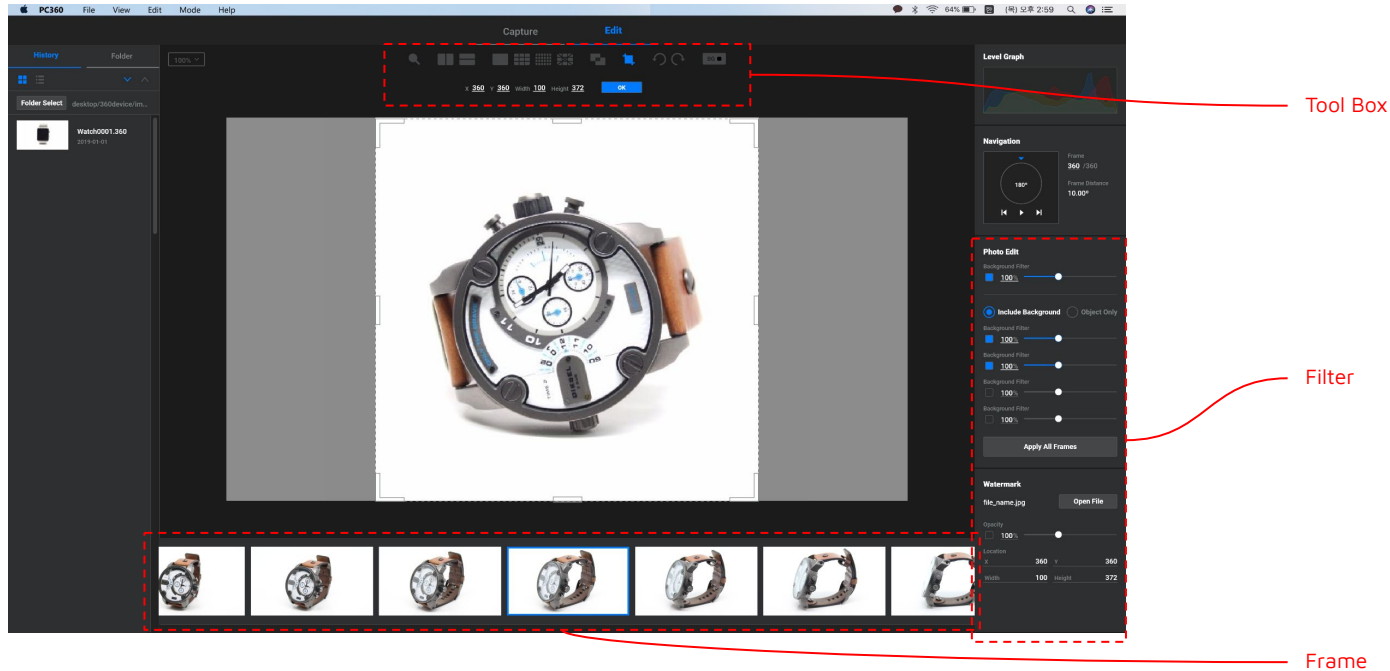

4. Check the image of the frame to be edited and adjust it using the function of toolbox

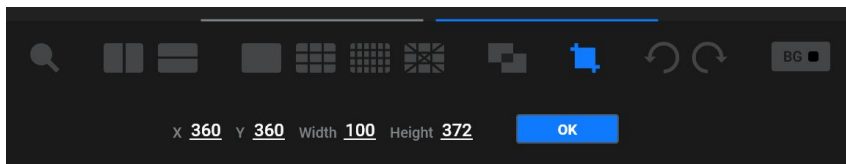

[Toolbox function]

Zoom	If you select the zoom function, a slide is created at the bottom, and the image is displayed by zooming in the viewer area Set the value using slider, minimum 100% - maximum 500%
Vertical Guideline	Display vertical guideline
Horizontal Guideline	Display horizontal guideline
No Grid	No grid
3x3 Grid	Display 3x3 grid
6x4 Grid	Display 6x4 grid
3x3 & Diagonal Grid	Display 3x3 & diagonal grid
1:1 Ratio	Display viewer ratio to 1:1
4:3 Ratio	Display viewer ratio to 4:3
Overlay	Display by superimposing front and back image
Crop	Crop the image by desired size Crop to a specified pixel based on the X,Y coordinates of the image. Can be cropped by 1:1, 4:3, 16:9 ratio
Undo / Redo	Undo / Redo the work

5. Check the image of the frame to be edited and adjust it using the function of the filter

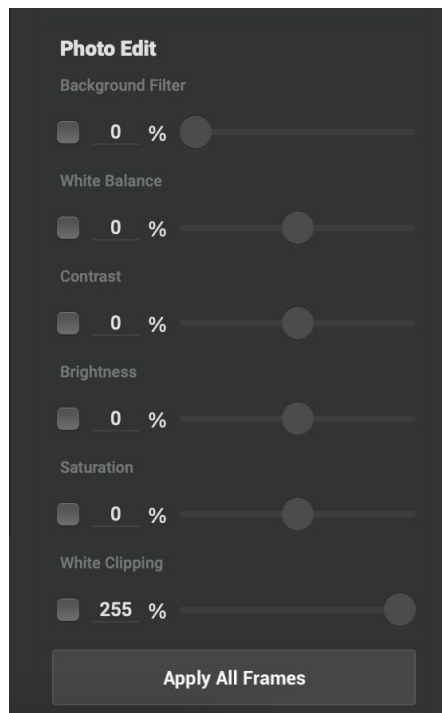
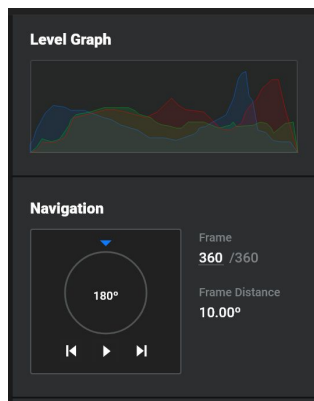

[Image information]

Level Graph	Display RGB histogram of viewer image
Navigation	Display current frame angle and can move to the desired frame

[Image Edit function]

Background Filter	Fills the background area with white, except for the object
White Balance	Control the color temperature of image
Contrast	Control the image contract value
Brightness	Control the brightness of image value
Saturation	Control the saturation value of image
White Clipping	Simple form of image segmentation. Create a binary image from a grayscale or full-color image. Used to separate "object" or foreground pixel fro background pixels to aid in image processing.
Apply All Frames	The setting value of image is applied to all frames in the timeline at once.
Watermark	Load image using open file. Control the transparency of loaded image by adjusting Opacity value Insert watermark with height/width px values set based on the X,Y coordinates of the image

Exporting 360 image and videos

1. Four image exporting methods are supported, including GIF, Image, and MP4. Can export to any desired methods.

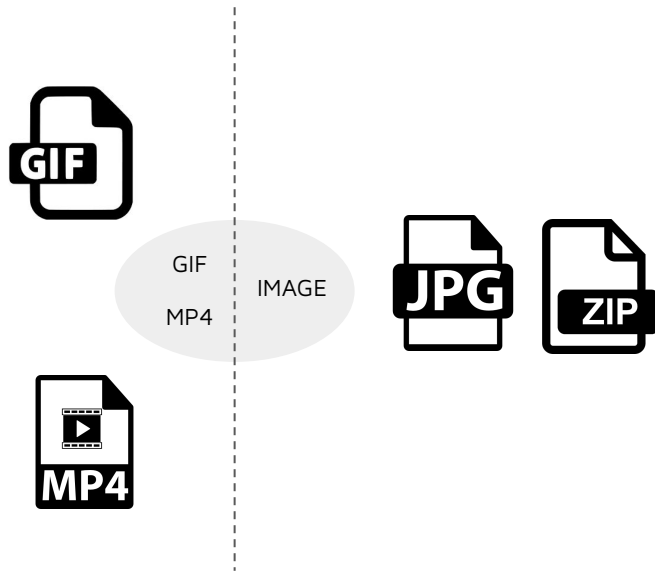

[Exporting Methods]

GIF	Export to 360 rotating gif file
Image	Export to one of jpg, bmp, png types
MP4	Export to 360 rotating mp4 file

1-1. Export to GIF file

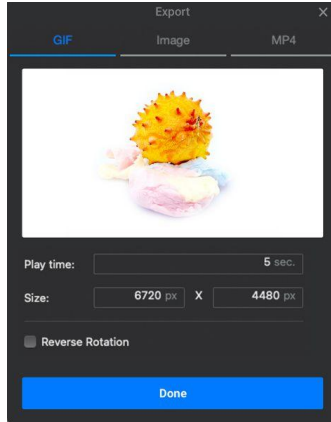

1-2. Export to image file

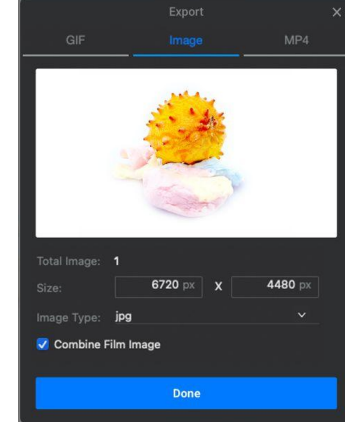

Preview	Image preview
Play time	Set the time it takes to play the last frame from the beginning
Size	Set the horizontal and vertical image px value to the correct ratio
Reverse Rotation	Set reverse rotation
Done	Set desired saving folder, name the file, and save

Preview	Image preview
Select Image	Export selected image in image list
Total Image	Number of exporting images
Size	Set the horizontal and vertical image px value to the correct ratio
Image Type	Select the exporting image type (jpg)
Done	Set desired saving folder, name the file, and save

1-3. Export to MP4 file

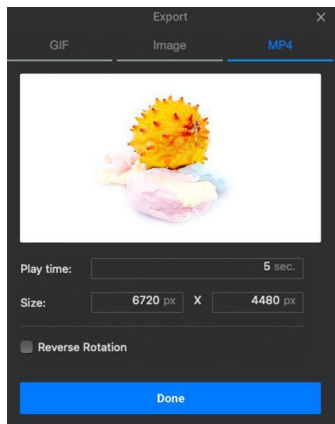

Preview	Video preview
Play time	Set the time it take to play the last frame from the beginning
Size	Set the horizontal and vertical image px value to the correct ratio
Reverse Rotation	Set reverse rotation
Done	Set desired saving folder, name the file, and save

MENU LIST

File	Open		Open the 360 project file
	Recent Open		Open the 360 project file saved recently
	Save		Save the 360 project file at the current location
	Save As		Save the 360 project file with the new name at the current or new location
	Import		Import the single image file
	Export	Quick GIF Export	Export as GIF file format
		Other Export	Export the other file format
View	Setting		Setting for
	Live View Ratio	1:1	See viewer with 1:1 ratio
		4:3	See viewer with 4:3 ratio
		16:9	See viewer with 16:9 ratio
	Centerline	Vertical	Show vertical guideline
		horizontal	Show horizontal guideline
	Grid	3x3	Show 3x3 grid
		6x4	Show 6x4 grid
		3x3 + Dial	Show 3x3 and diagonal grid
		Toggle Grid	Turn off/on grid

	Focus Zoom	x1	Zoom x1
		x5	Zoom x5
		x10	Zoom x10
		Toggle Zoom	Turn off/on zoom
Edit	Undo		Undo action
	Redo		Redo action
	Crop		Crop image
	Zoom +		Zoom in
	Zoom -		Zoom out
	Overlay		Overlay images
	Rotate		Rotate image
	Add Watermark		Insert watermark
Mode	360 Image		360 image mode
	Single Shot		Single shot mode
	Video		Video mode
Help	Help Center		Help center
	License		License

Copyright

Copyright © 2021 Orangemonkie INC.

This manual protected under international copyright laws and treaties.No part of this manual may be reproduced, distributed, translated, or transmitted in any form or by any means, electronic or mechanical, including photocopying, recording, or storing in any information storage and retrieval system, without the prior written permission of Orangemonkie INC.